

Rat Rig

06. Spool Holder Assembly

Written By: Simon Davie



INTRODUCTION

[video: <https://youtu.be/3zXnb3MqMR0>]

Step 1 — Prepare the spool holder parts

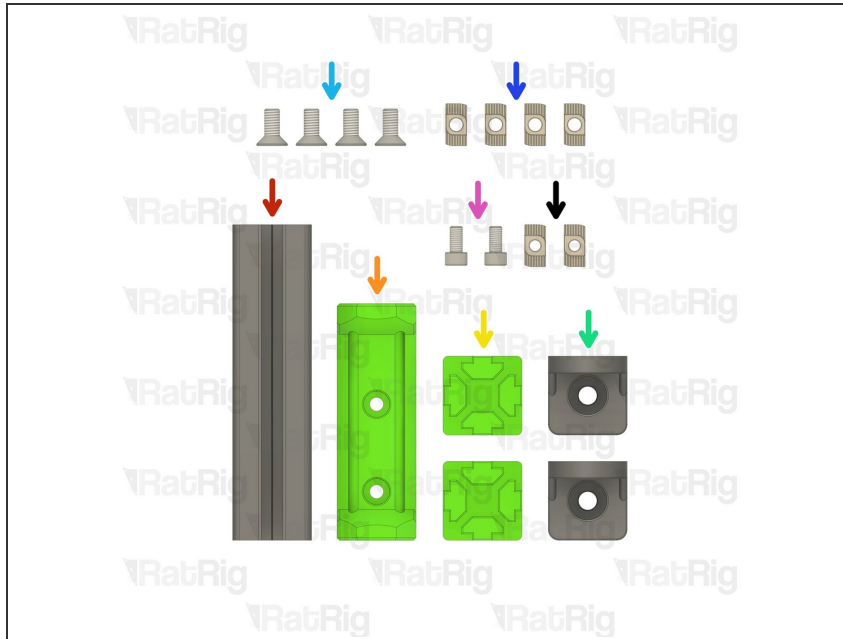

- 1x 120mm 3030 Extrusion
- 3030_spool_holder printed part
- 3030_end_cap printed part
- 2x 3030 Cast Bracket
- 4x M6x14 Countersunk Hex Head Screw
- 4x 3030 Drop-in T-Nut - M6
- 2x M5x10 Cap Head Screw
- 2x 3030 Drop-in T-Nut - M5

Step 2 — Assemble the spool holder - Part 1

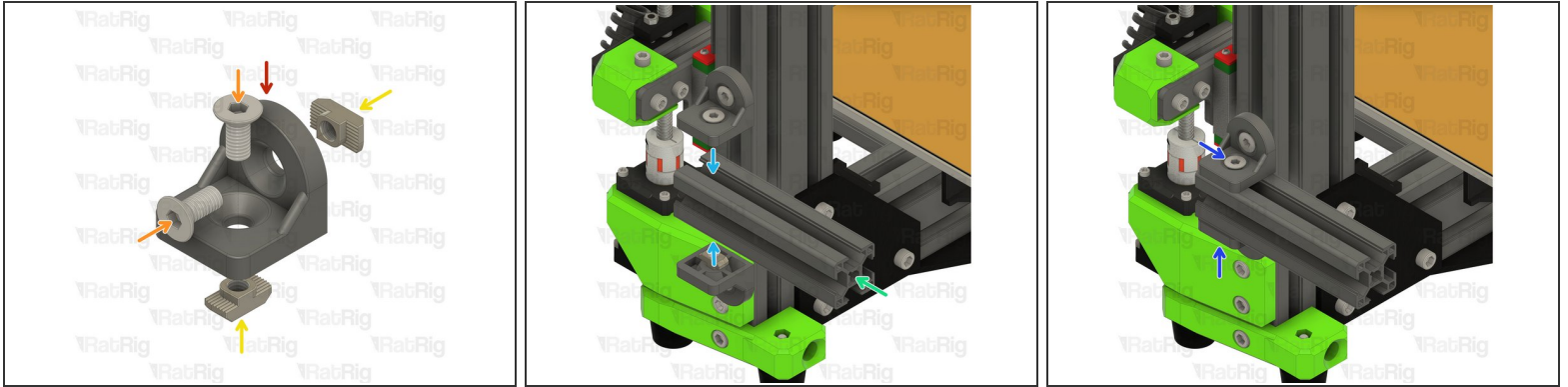

- 3030 Cast Bracket
- M6x14 Countersunk Hex Head Screw
- 3030 Drop-in T-Nut - M6
- ① Loosely thread the 3030 T-Nuts onto the M6x14 screws. Do not tighten them at this point
- 120mm 3030 Extrusion
- Install the cast bracket assemblies onto the 3030 extrusion as shown
- Fasten the two marked M6x14 countersunk screws

Step 3 — Assemble the spool holder - Part 2

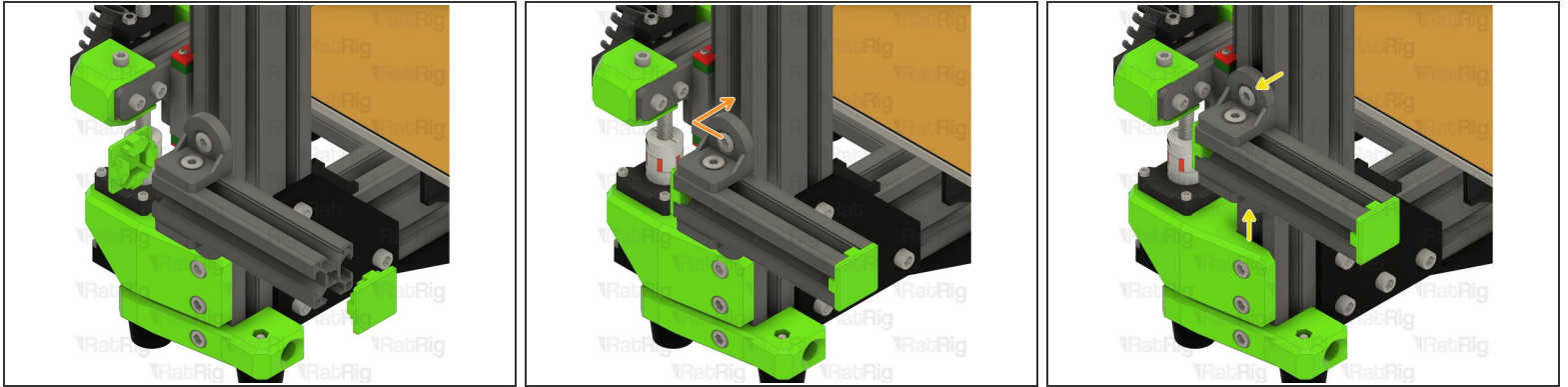

- 3030_end_cap printed part
- ① Install the 3030 extrusion end caps by carefully pushing them into place
- Install the spool holder assembly onto the V-Minion frame as shown
- Fasten the two marked M6x14 countersunk screws to secure the spool holder to the frame

Step 4 — Assemble the spool holder - Part 3

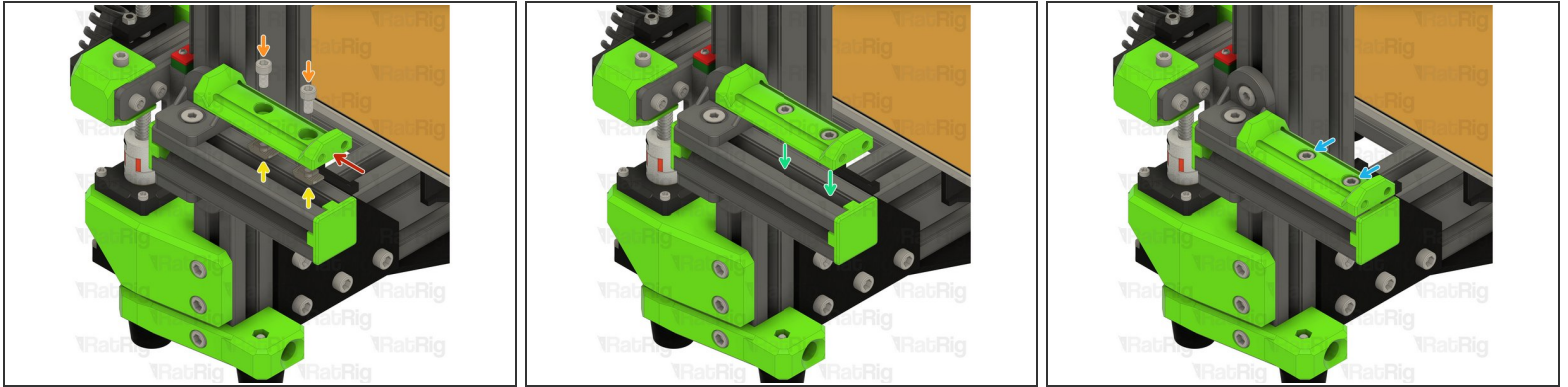

- 3030_spool_holder printed part
- M5x10 Cap Head Screw
 - ❗ Insert the M5x10 cap head screws into the printed part.
- 3030 Drop-in T-Nut - M5
 - ❗ Loosely thread the 3030 T-Nuts onto the M5x10 screws. Do not tighten them at this point
- Install the printed part onto the 3030 extrusion as shown
- Fasten the two M5x10 screws to secure the printed part to the 3030 extrusion
 - ⚠ Take care not to over tighten the M5x10 screws as you can damage the printed part

Step 5 — Next guide



- ❗ Continue with the next guide: [07. EVA Assembly](#)