

Rat Rig

15. Spool Holder v2.0

Written By: Simon Davie



Step 1 — Assemble the 90 Degree Corners (x2)

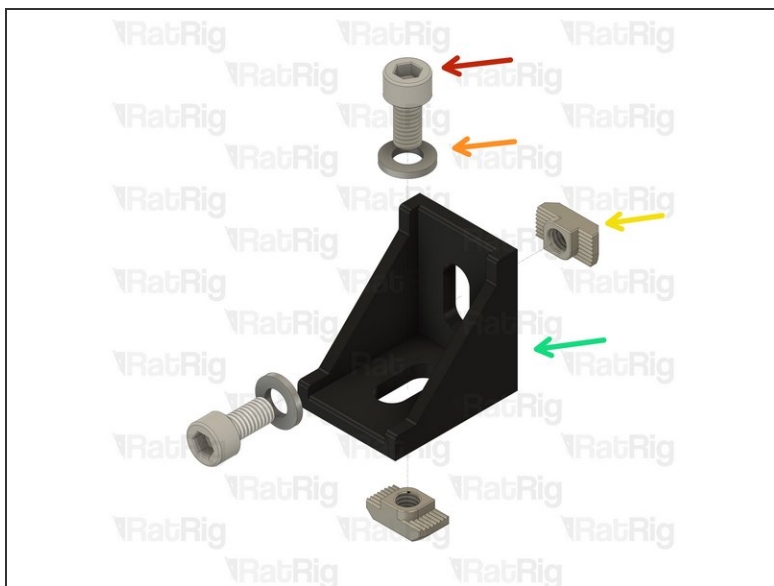

- M6x12 Cap Head Screw
- M6 Washer
- 3030 Drop-in T-Nut M6
- Cast 90 Degree Corner Bracket for 3030

 Loosely thread the 3030 T-Nuts onto the M6x12 screws. Do not tighten them at this point.

Step 2 — Assemble the Main Body

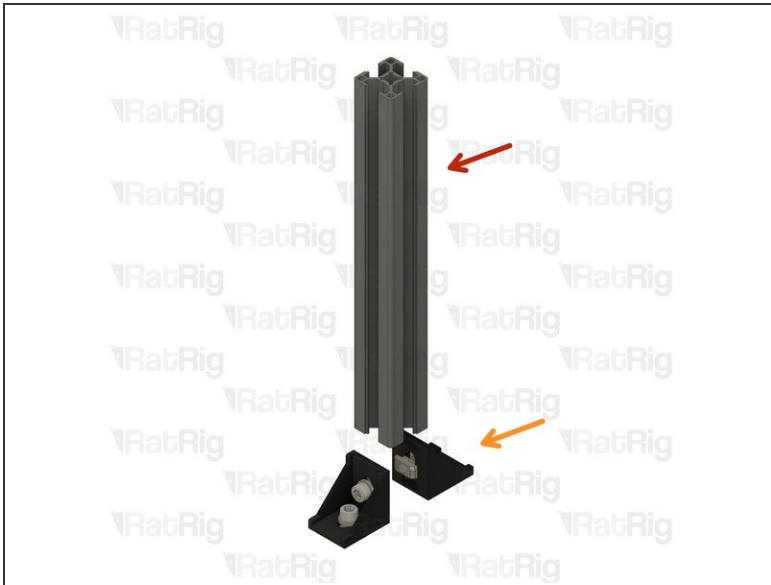

- 3030 Extrusion - 234mm
- Install the two 90 degree corners on to one end of the 3030 extrusion.
- Tighten the M6x12 cap head screws connecting to the 3030 extrusion using a 5mm hex key.
- ① Make sure the 90 degree corners are both flush, and square, with the end of the extrusion. before tightening

Step 3 — Assemble the arm supports

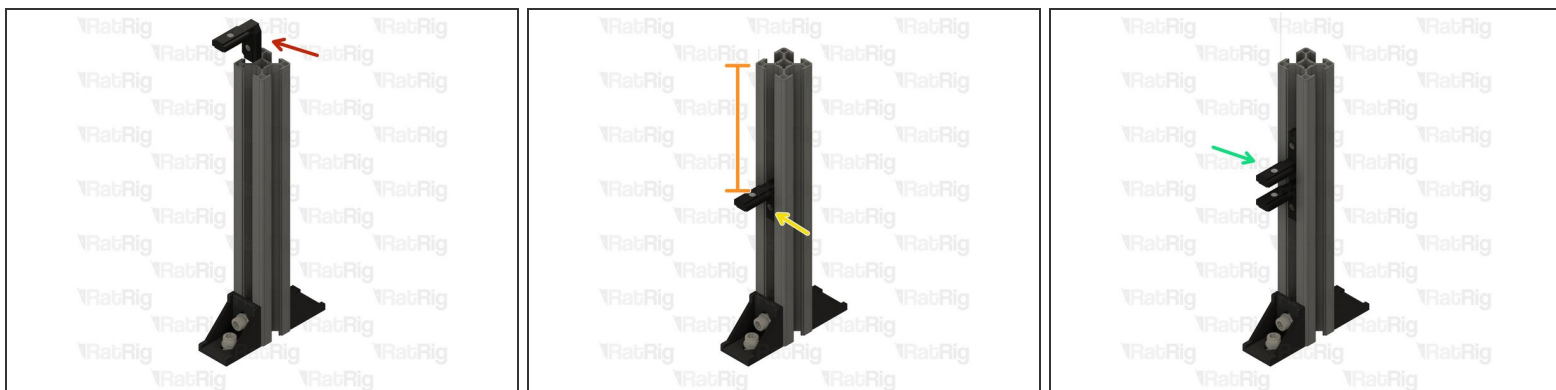

- 3030 Inside Hidden Corner Bracket

- ⓘ Check that the grub screws on the inside corners are retracted to allow installation into the 3030 extrusion.
- Slide one inside corner into the 3030 extrusion. Position it so that there is a measurement of 100mm from the top of the inside corner, to the top of the extrusion.
- Tighten the indicated grub screw with a 3.0mm hex key, securing the corner into place.
- Slide the remaining inside corner into the 3030 extrusion. Make sure the orientation mirrors that of the previously installed lower corner.
- ⚠ Do not fasten the grub screw on the second inside corner just yet.

Step 4 — Install the arm

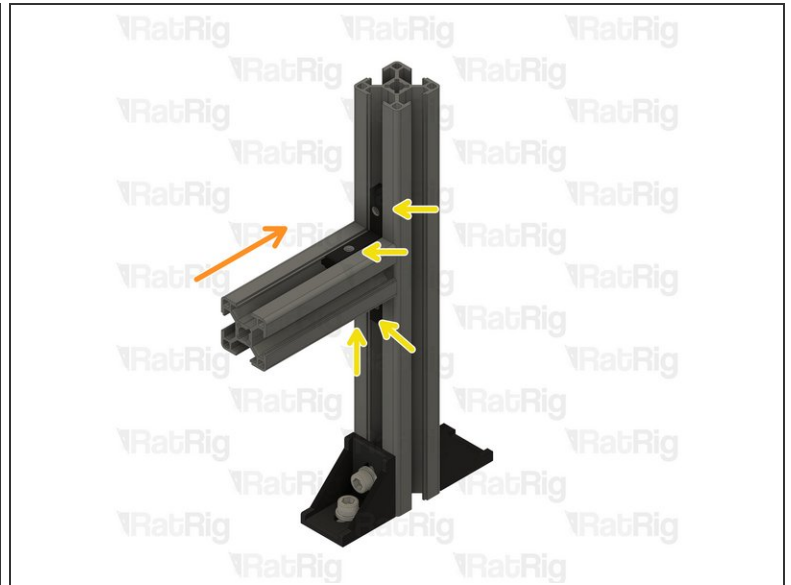

- 3030 Extrusion - 87mm
- Slide the 87mm length of 3030 extrusion onto the inside corners.
- Tighten all four grub screws on the inside corners to secure the arm in place.

Step 5 — Assemble the printed spool holder



- M5x10 Cap Head Screw

- 3030 Drop-in T-Nut M5

- Insert the M5x10 cap head screws into the printed part.

- *i* Loosely thread the 3030 T-Nuts onto the M5x10 screws. Do not tighten them at this point.

Step 6 — Final Assembly



- Install the printed assembly onto the arm of the spool holder, making sure that the M5 T-Nuts drop into the 3030 extrusion slot.

- Gently tighten the two M5x10 cap head screws using a 4mm hex key.

⚠ Do not over tighten these screws as doing so could cause damage to the printed part.

- Install the 3030 extrusion end caps by carefully pushing them into place.

Step 7 — Installation

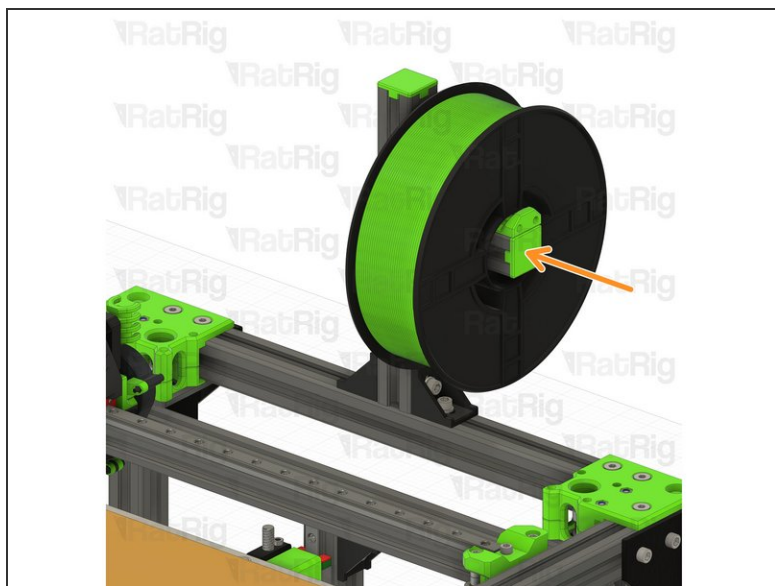
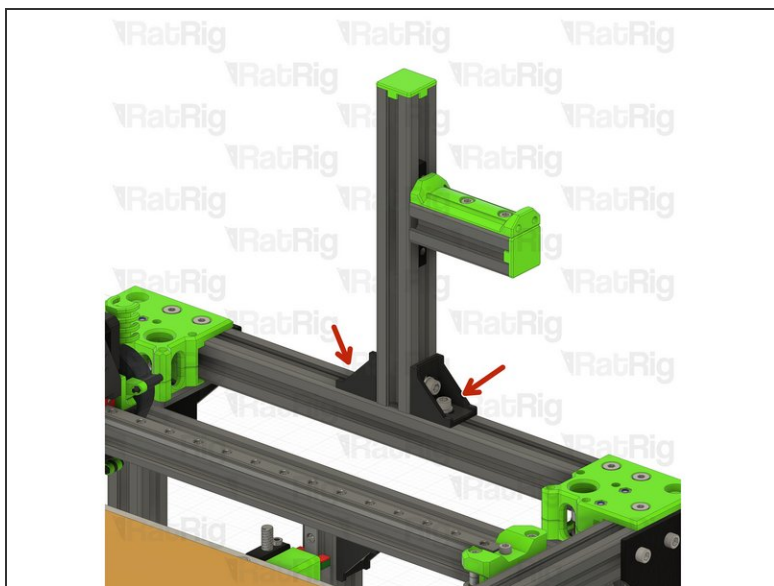

- Install the spool holder to the frame where desired. Simply put the spool holder where desired and then fasten the two M6x12 cap head screws.
- Slip your filament spool into place and you are ready to begin using the holder. The printed part keeps the spool secured when it spins.

Step 8 — Finished!

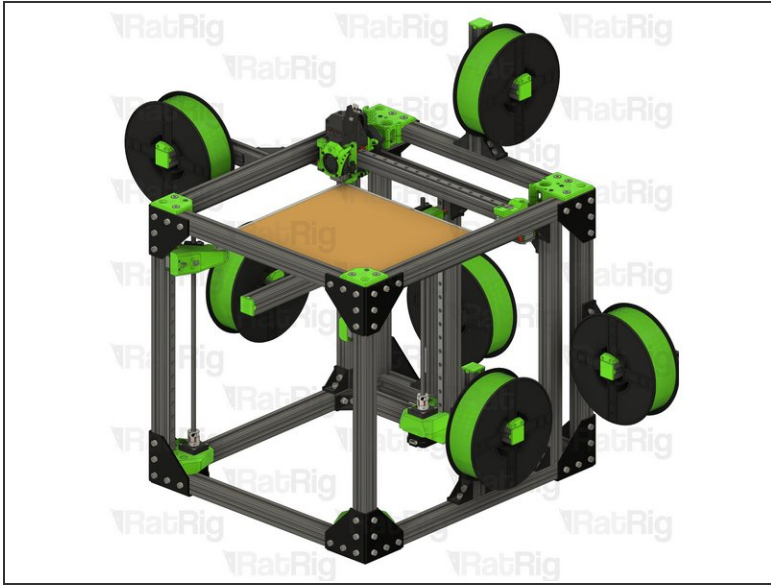

- The Rat Rig Spool Holder v2 is designed to be versatile and customisable to your needs. Here are a few examples of different mounting positions on the Rat Rig V-Core 3.
- Two optional 84mm lengths of PTFE / bowden tube can be installed into the spool holder to allow for even smoother movement of the spool.