

# Rat Rig

## 06. Spoiler Board Support

Written By: Rat Rig

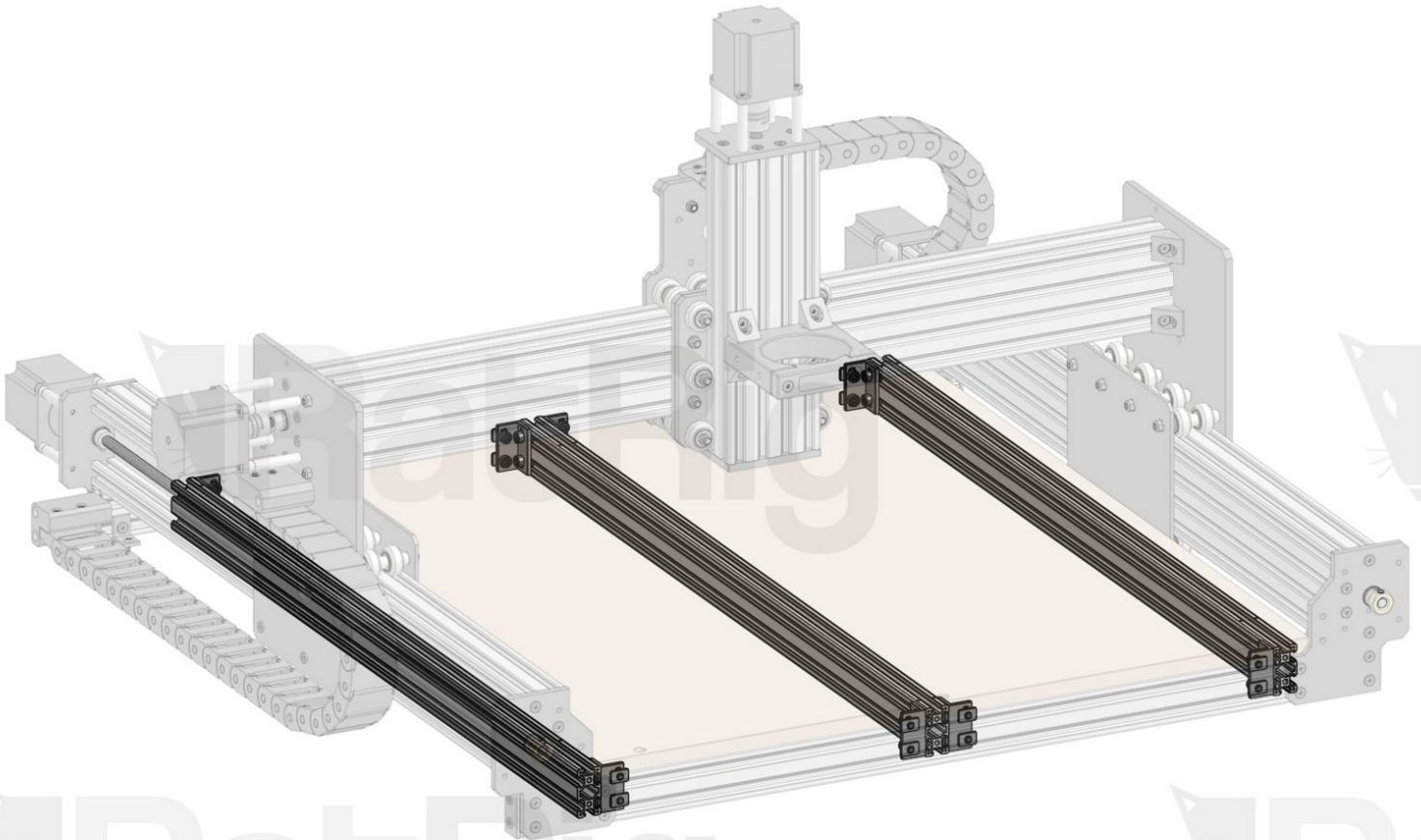
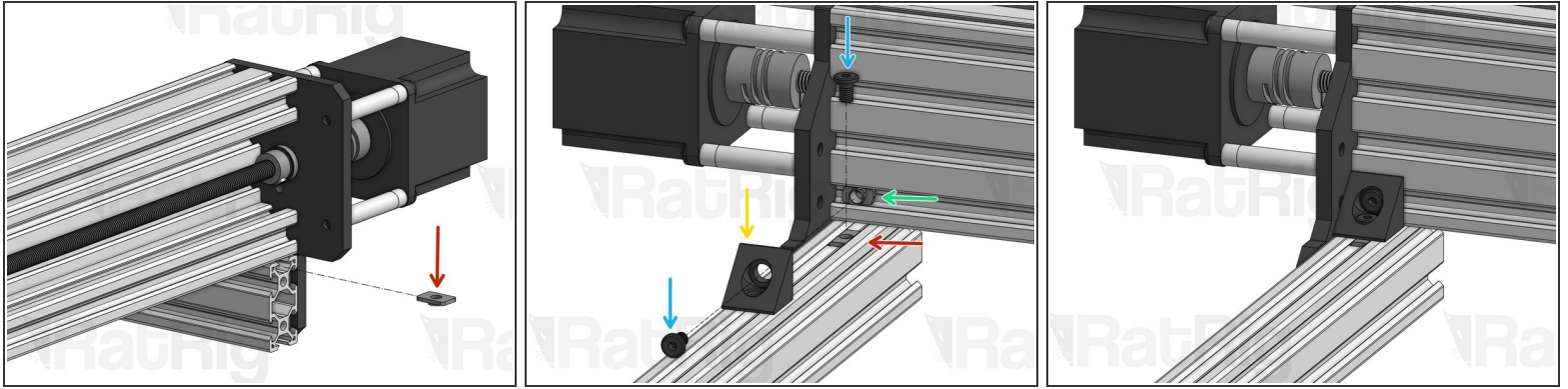

**Step 1 — Reinforce the base frame with Angle Corners (x4)**

- T-Nut M5. Insert only the tip and then give it a gentle tap with your finger, to make sure it passes underneath the C-Beam all the way to the other side.
  - Low Profile Screw M5x8mm
  - 90 Degree Angle Corner Connector
  - Drop-in T-Nut
- ⓘ Repeat this step for all 4 corners of your frame.

## Step 2 — Insert T-Nuts inside the slots of the X Base 2040 Profiles

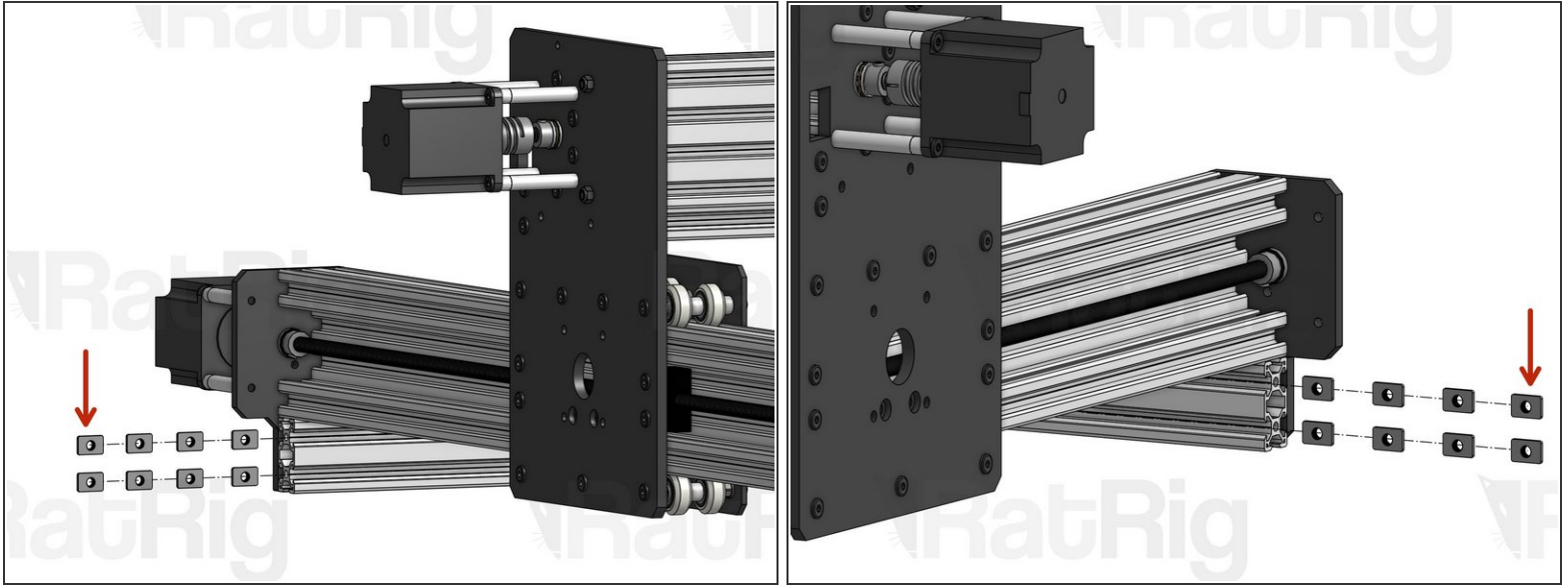

- **T-Nut M5.** Insert them inside the internal slots of both X Base 2040 profiles (4 slots in total). You should insert the same quantity on the top and bottom slot. Take note of the orientation of the T-Nuts (Flat side facing outwards). The number of T-Nuts per slot depends on the size of your Workbee Variant. Check below:
- **Workbee 5050:** 2 T-nuts per slot, 8 in total.
- **Workbee 1050:** 2 T-nuts per slot, 8 in total.
- **Workbee 7575:** 4 T-nuts per slot, 16 in total (illustrated in the pictures).
- **Workbee 1010:** 6 T-nuts per slot, 24 in total.
- **Workbee 1510:** 6 T-nuts per slot, 24 in total.
- **Workbee 1515:** 8 T-nuts per slot, 32 in total.

### Step 3 — Set up Double L Brackets

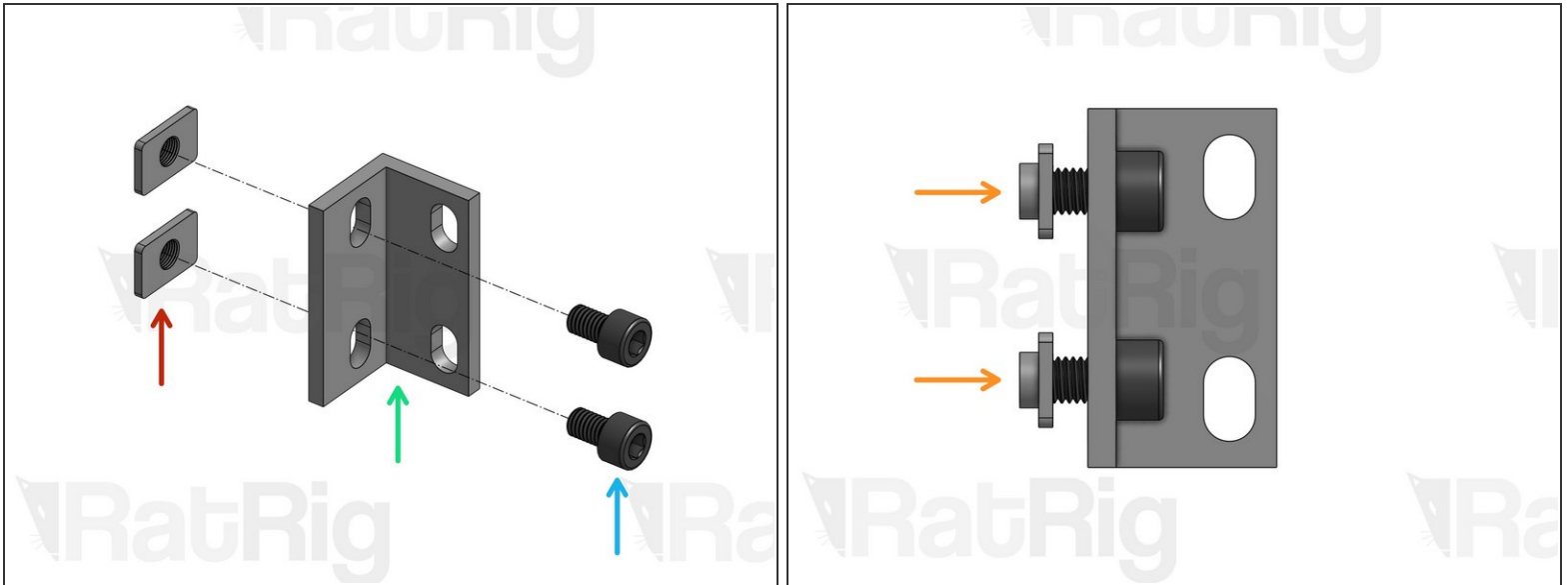

- T-Nut M5
  - Double L Bracket
  - Low Profile Screw M5x8mm (picture is outdated, it shows a cap head screw)
  - Screw T-Nuts into position, but don't tighten.
- ⓘ Repeat for all Double L Brackets included in your kit (number varies depending on the size of your Workbee)

## Step 4 — Mount Double L Brackets on Y Spoiler Support 2040 Profiles



- **Outer Support Profiles (x2):** mount 1 Double L Bracket on both ends of each profile and tighten the screws only enough for the brackets to hold their position.
  - **Inner Support Profiles (quantity depends on the size of your Workbee):** mount 2 Double L Brackets on both ends of each profile and tighten the screws only enough for the brackets to hold their position.
- ⓘ The brackets should be mounted on the same face of each profile and should be flush with the end of the profile.

## Step 5 — Mount Spoiler Board Supports on Frame

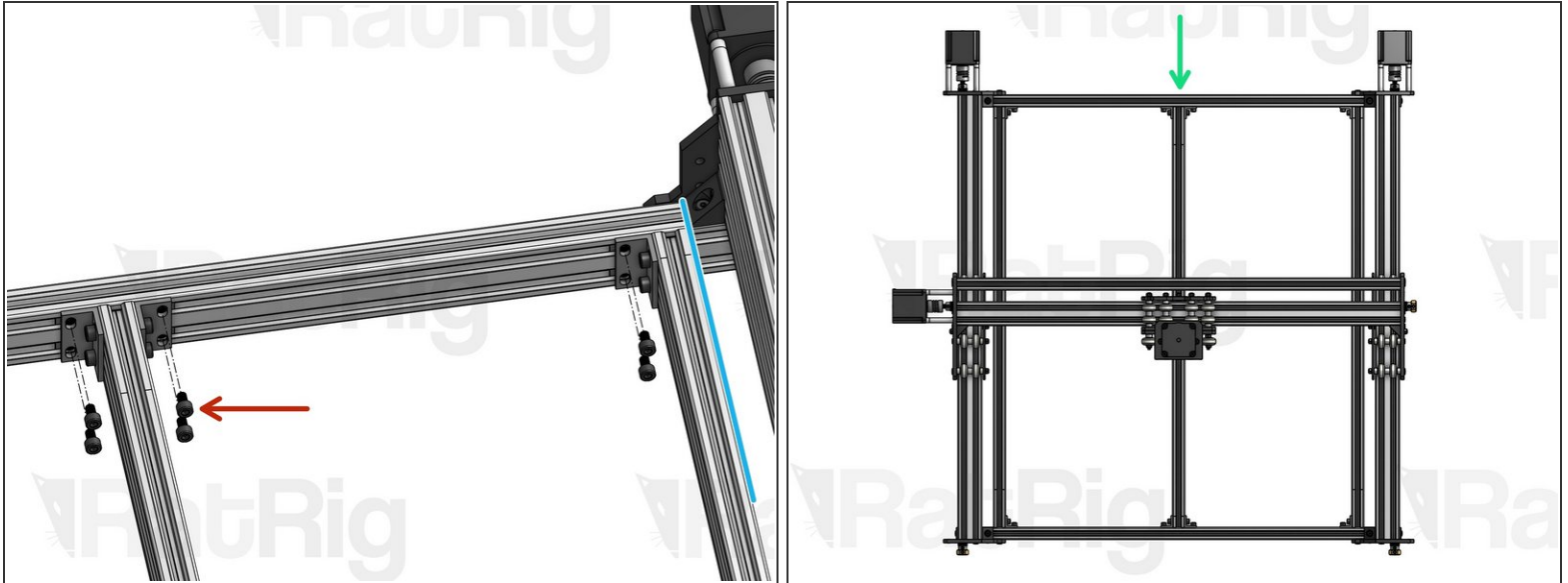

- Low Profile Screw M5x8mm (picture is incorrect, it shows a cap head screw)
- Place one outward support profile on the left side of your frame and the other on the right, aligned with the ends of the Angle Corners. Slide 2 T-Nuts (which you already inserted on the X Base 2040 profiles on step 2) behind each L bracket, aligning them with the holes, and slightly tighten the inner supports with the Cap Head Screws M5x8mm.
- Repeat the process for the inner support profiles **(not applicable for Workbee 5050 and 1050)**, which should be equidistant from each other (specific distances will depend on your Workbee size).
- After all profiles are properly positioned and aligned, give the final tightening on every Low Profile Screw M5x8mm.

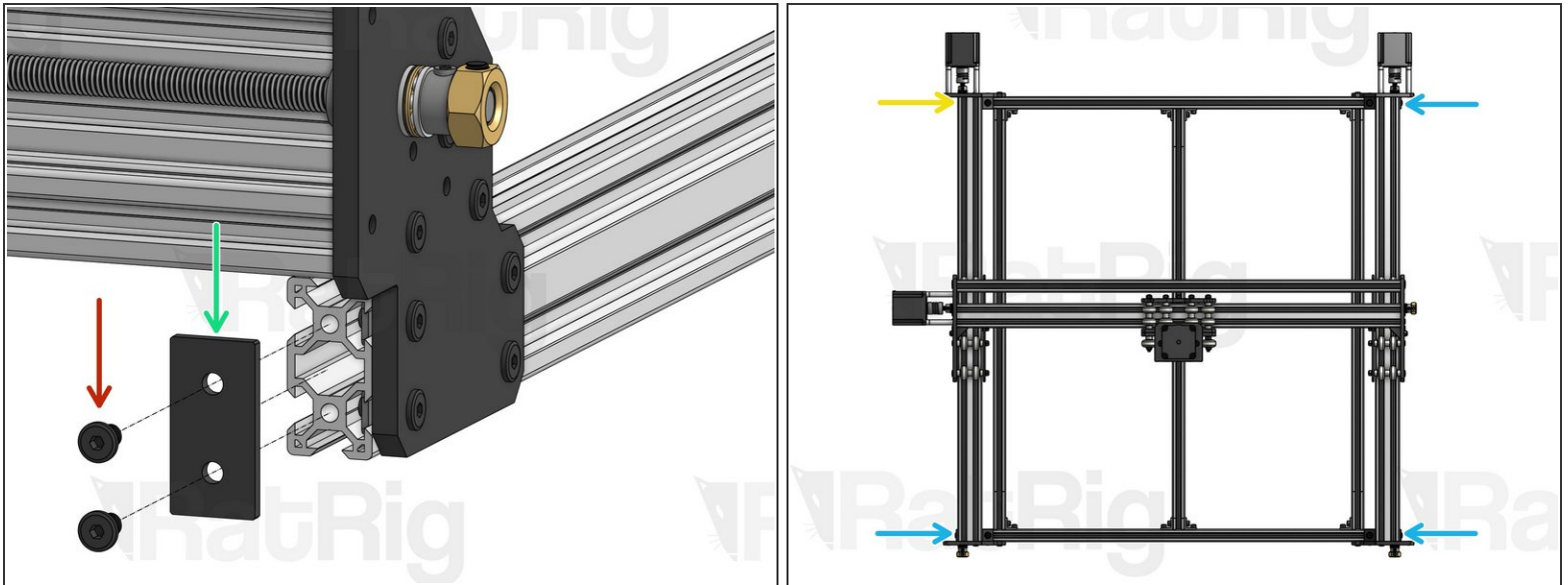
**Step 6 — Mount End Caps on X Base 2040 Profiles (x3)**

- Low Profile M5x8mm
- 2020 End Cap (x2) (picture needs to be updated, it shows a 2040 End cap)
- Attach End Caps to these 3 corners of your base
- Do not attach an End Cap to this corner of your base



## Step 7 — Attach the Workbee to your tabletop

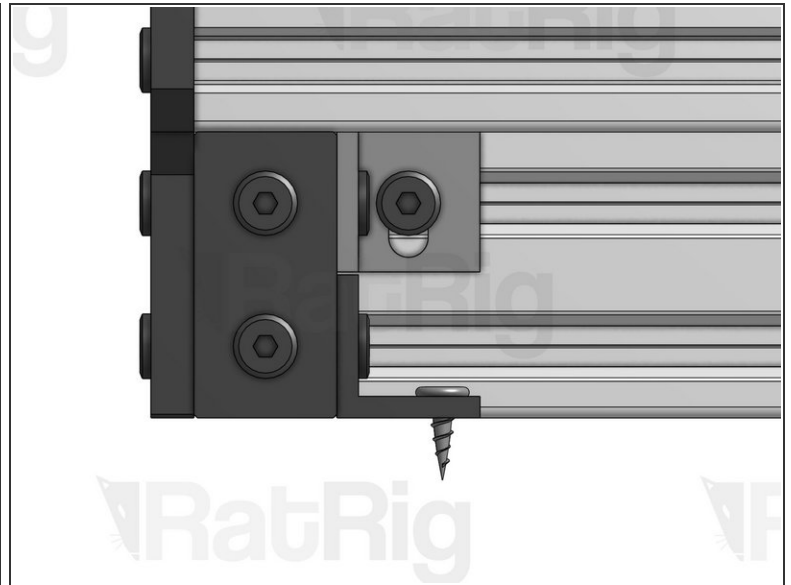
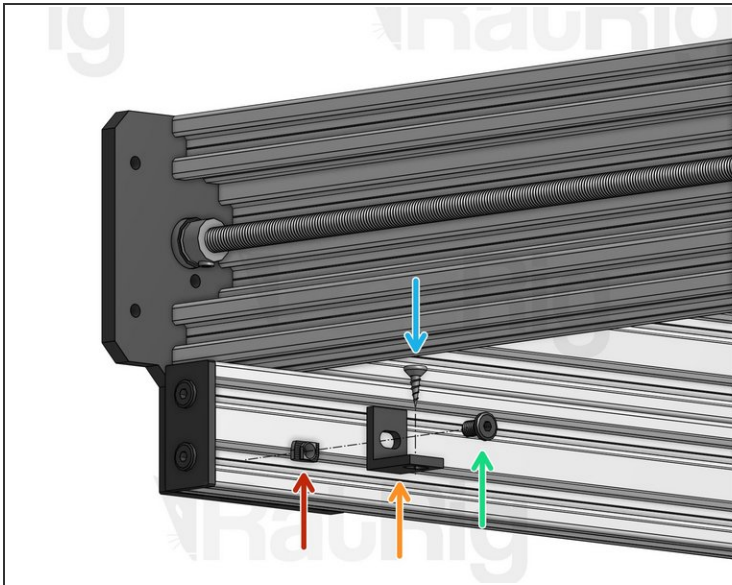

- Drop in T-Nut M5
- Single L Bracket
- Low Profile Screw M5x8mm
- Round Head Cutting Screw
- ⓘ Repeat for all 4 corners of your frame.