

Rat Rig

2.1. Wheel Assembly

Written By: Rat Rig

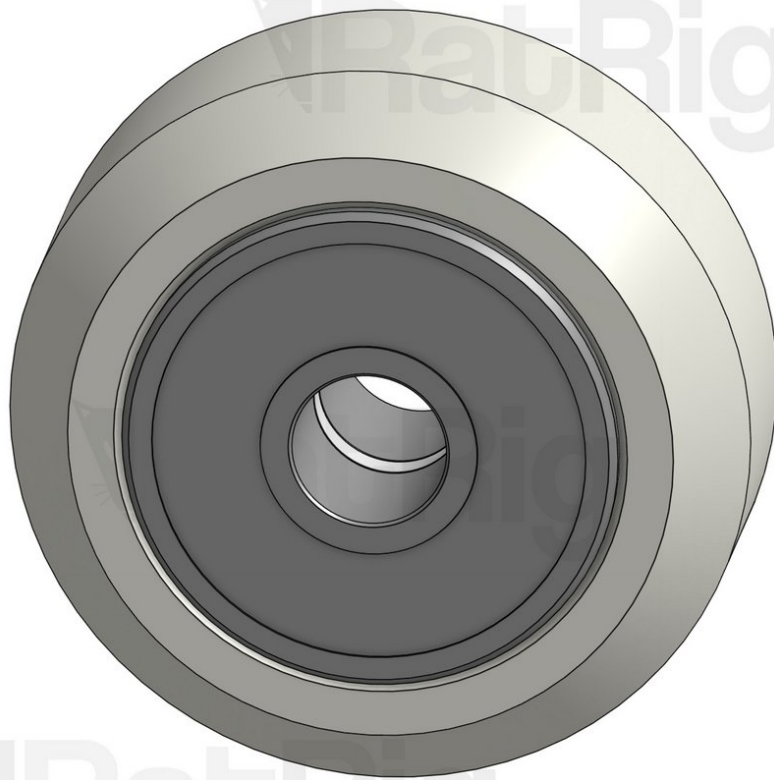

Step 1 — Wheel Assembly

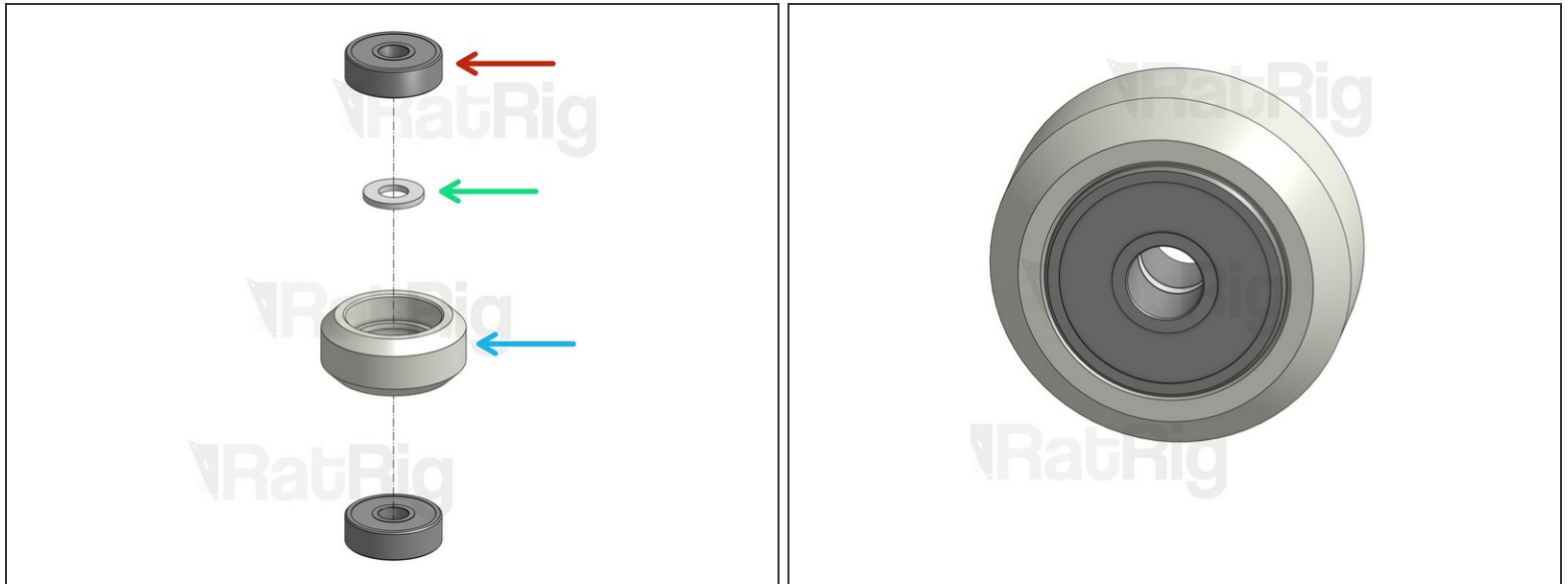

- Ball Bearing - 625 2RS
- Mini Precision Shim - 8 x 5 x 1mm
- Xtreme Solid V Wheel
- Assemble all Xtreme Wheels included in the kit. Make sure you don't forget the mini shim between the bearings, or your wheels won't work properly.
- Avoid applying uneven forces on your bearings, or you may damage them. Recommended assembly method is:
 - Place one bearing on a flat surface and press the wheel against it until the bearing slides inside it.
 - Place the mini shim and align it with the hole.
 - Place the second bearing on top of the wheel and press it down using an object with a flat surface, to ensure that even pressure is applied.